

Municipality of  
Brooke-Alvinston  
**OFFICIAL PLAN**  
**SCHEDULE "A"**

**LEGEND**

- Assessment Parcels
- Rivers - Streams - Drainage
- Roads
- County Roads
- Municipal Boundary
- Schedule Inset Boundaries ("Part 1" .... "Part 2")
- Waterbodies

**Official Plan - Designations**

- Agricultural Area

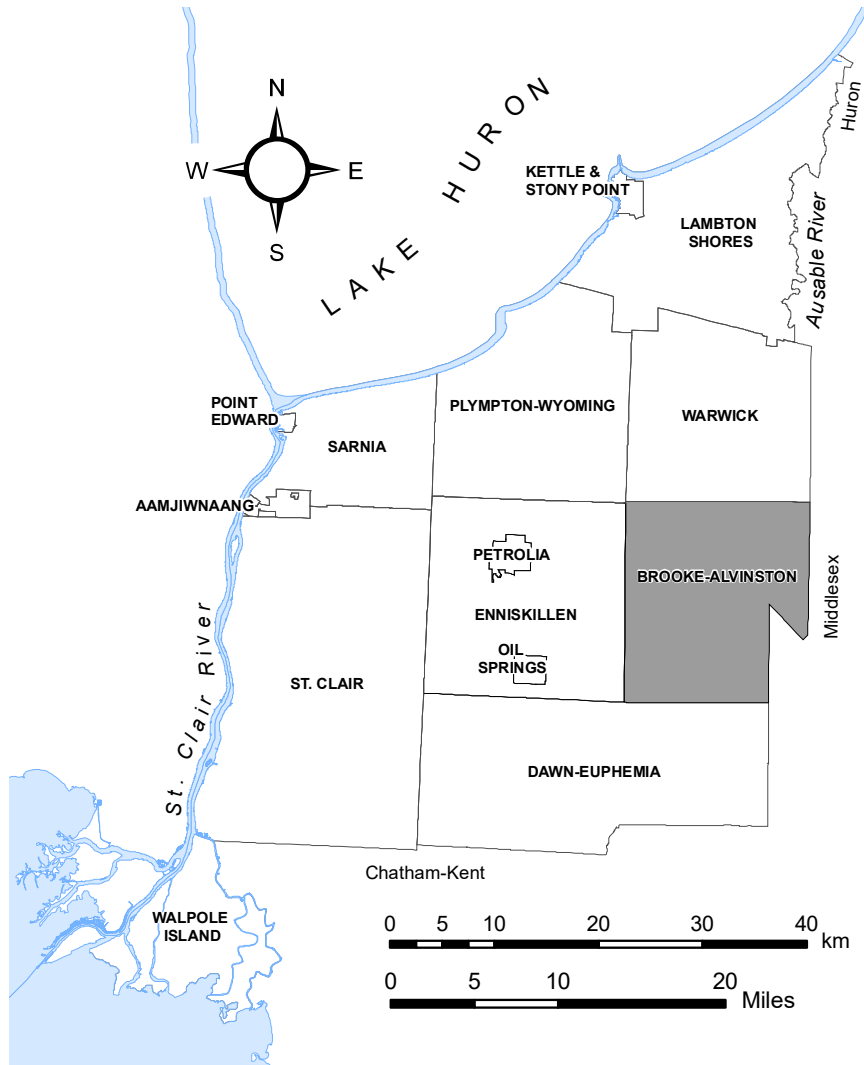

2023  
**DRAFT**

**Reference**

Disclaimer: These digital mapping products have been produced on the County of Lambton's Geographic Information System. Data provided herein is derived from sources with varying levels of accuracy and currency. This is not a survey product. The County of Lambton disclaims all responsibility for the accuracy or completeness of information contained herein. The County of Lambton assumes no responsibility for errors arising from use of these digital mapping products.

The Official Plan information contained herein is current as of the last recorded amendment noted under "Official Plan Amendments".

- Cadastral database is current to November 2022.

Projection: UTM NAD 83 Zone 17

Consultant: NPG Planning Solutions, April 2023.

COUNTY OF LAMBTON  
Planning and Development Services, April 2023.

www.lambtononline.ca

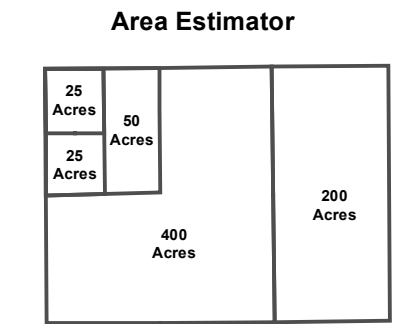

Notes: Area Estimator generalized blocks (shown at left) are scaled to represent typical area measures.  
Acre area measures can be converted to hectares (ha) by dividing by (2.471).

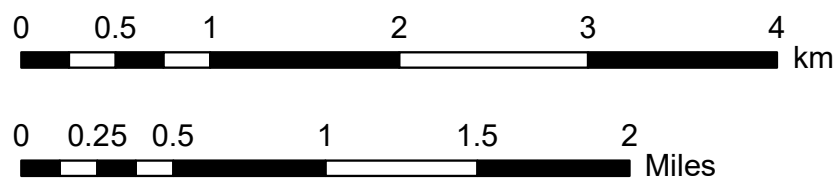
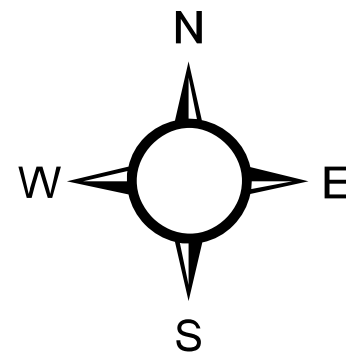

Municipality of  
Brooke-Alvinston  
**OFFICIAL PLAN**  
**SCHEDULE "A"**

to By-law No. xx of 2023

Passed this xx day of xxxxxxx, 2023

David Ferguson, Mayor

Janet Denkers, Clerk-Administrator

**Official Plan Amendments**

xx





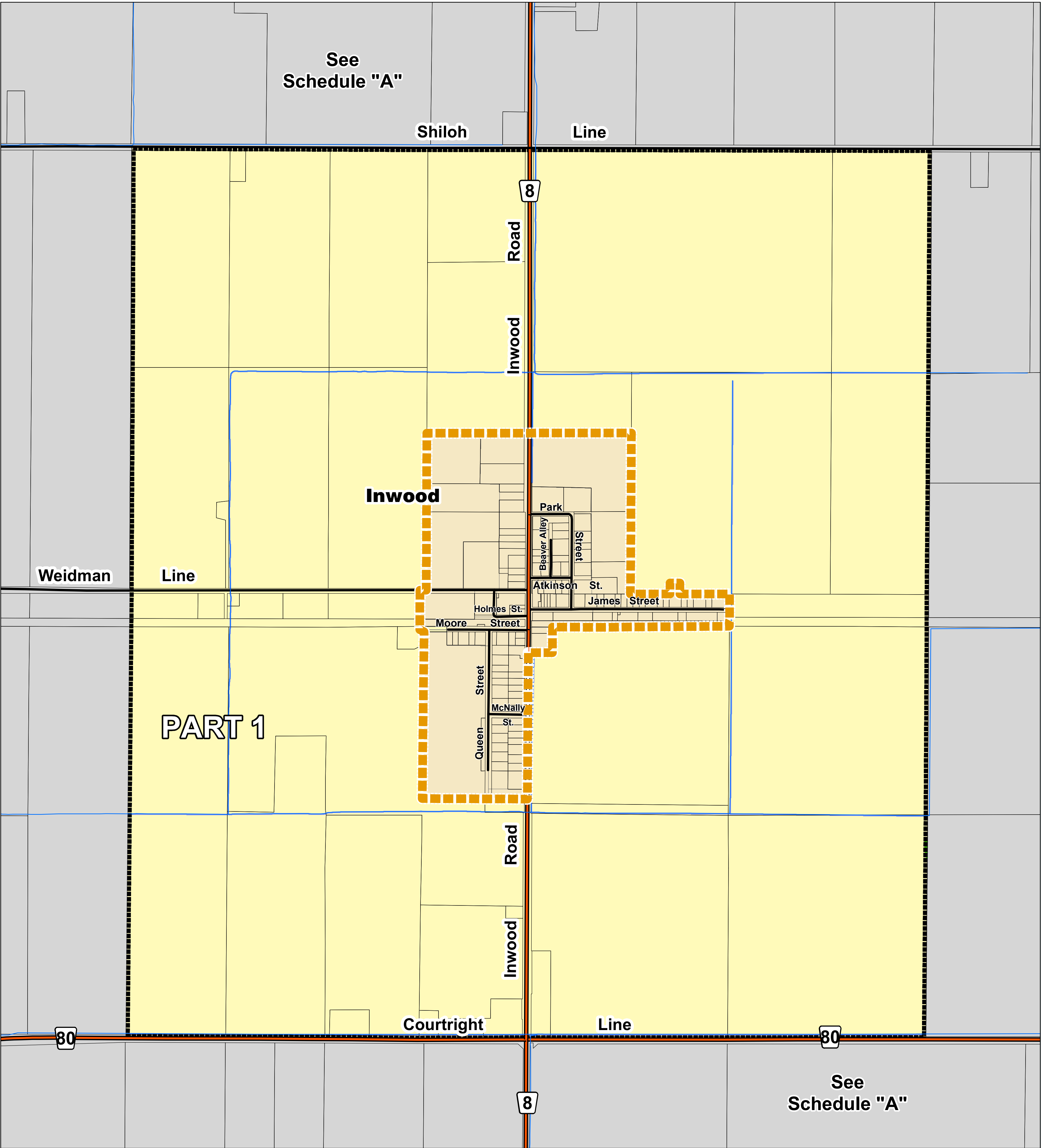

Municipality of  
Brooke-Alvinston  
**OFFICIAL PLAN**  
PART 1 to Schedule "A"  
(Inwood)

LEGEND

- Assessment Parcels
- Rivers - Streams - Drainage
- Roads
- County Roads
- Schedule Inset Boundaries ("Part 1" .... "Part 2")

Official Plan - Designations

- Agricultural Area
- Secondary Settlement Area

Lambton County  
Official Plan - Designations

- Secondary Settlement Area Boundary

The settlement area boundary shown is derived from the County of Lambton Official Plan and does not form part of the Brooke-Alvinston Official Plan. It is provided as a visual aid for information purposes only.

2023  
DRAFT

Reference

Disclaimer: These digital mapping products have been produced on the County of Lambton's Geographic Information System. Data provided herein is derived from sources with varying levels of accuracy and currency. This is not a survey product. The County of Lambton disclaims all responsibility for the accuracy or completeness of information contained herein. The County of Lambton assumes no responsibility for errors arising from use of these digital mapping products.

The Official Plan information contained herein is current as of the last recorded amendment noted under "Official Plan Amendments".

- Cadastral database is current to November 2022.

Projection: UTM NAD 83 Zone 17

Consultant: NPG Planning Solutions, April 2023.

COUNTY OF LAMBTON  
Planning and Development Services, April 2023.

www.lambtononline.ca

Area Estimator

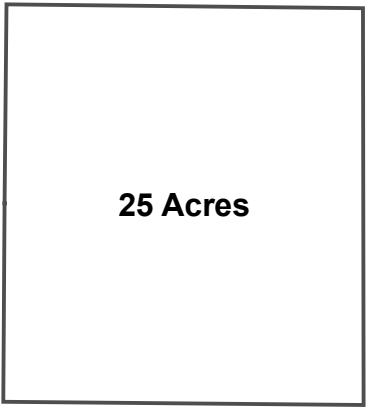

Notes: Area Estimator generalized blocks (shown at left) are scaled to represent typical area measures.  
Acre area measures can be converted to hectares (ha) by dividing by (2.471).

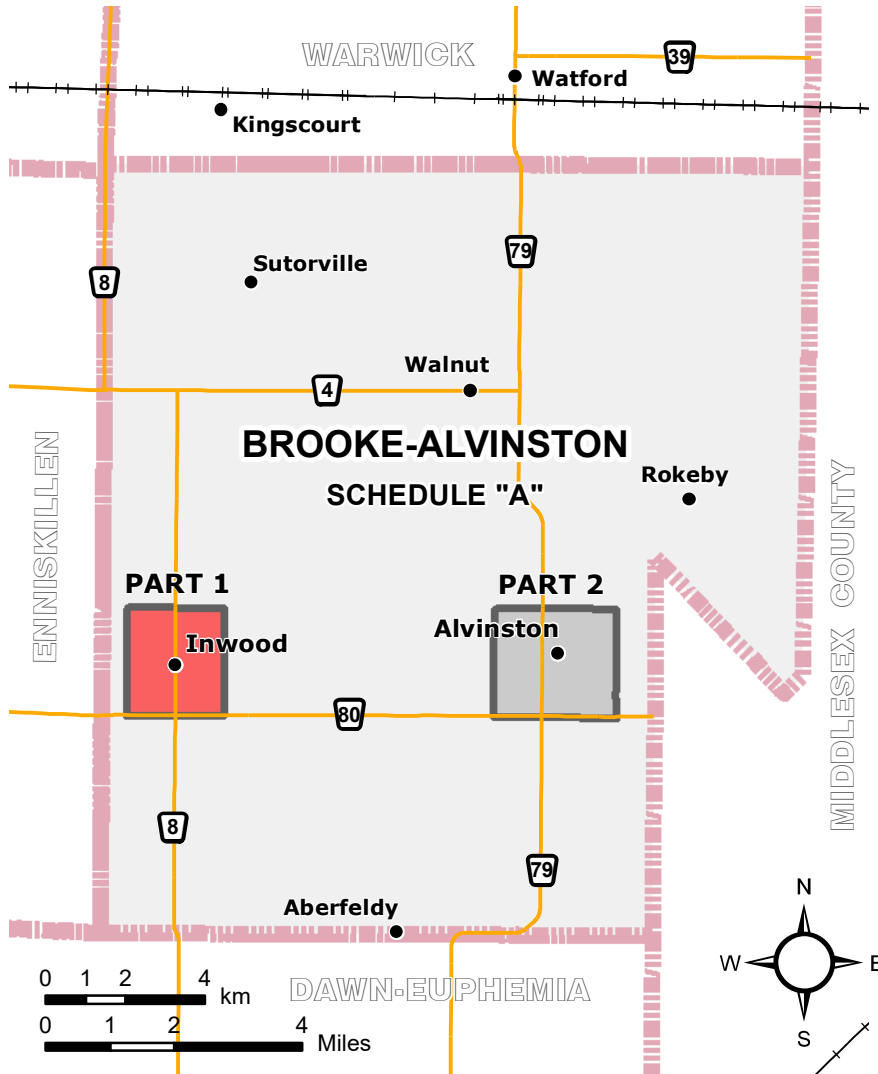
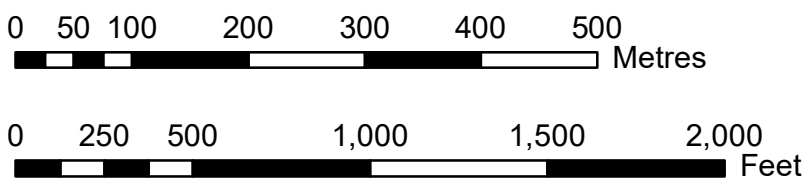
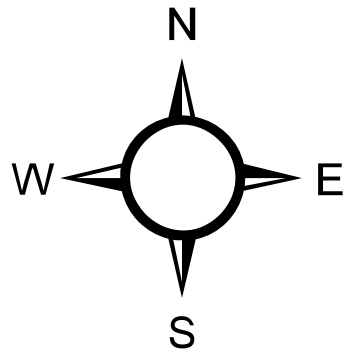

Municipality of  
Brooke-Alvinston  
**OFFICIAL PLAN**  
PART 1 to Schedule "A"  
(Inwood)

to By-law No. xx of 2023

Passed this xx day of xxxxxxxx, 2023

David Ferguson, Mayor

Janet Denkers, Clerk-Administrator

Official Plan Amendments

xx





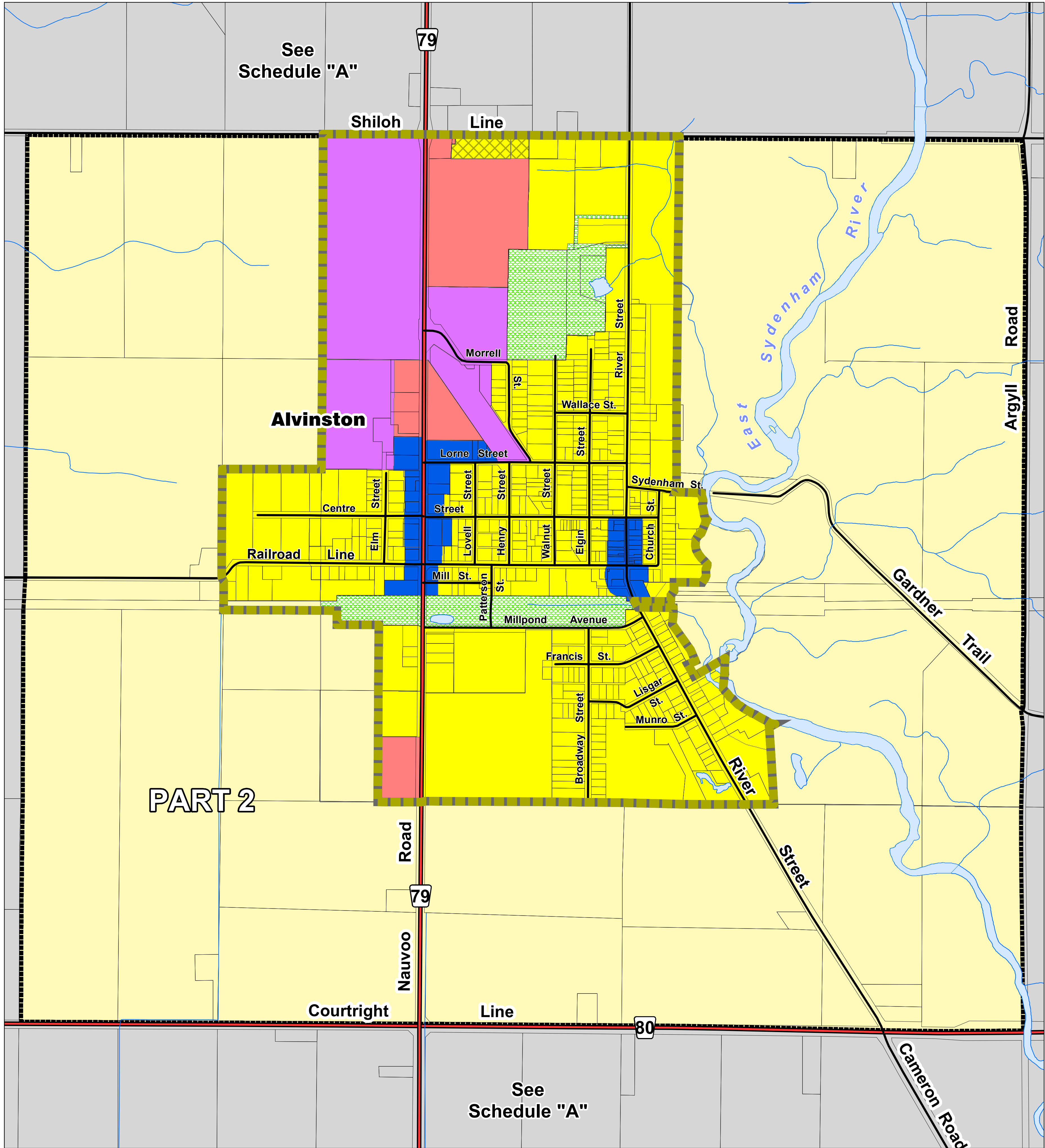

Municipality of  
Brooke-Alvinston  
**OFFICIAL PLAN**  
PART 2 to Schedule "A"  
(Alvinston)

LEGEND

- Assessment Parcels
- Rivers - Streams - Drainage
- Roads
- County Roads
- Schedule Inset Boundaries ("Part 1" .... "Part 2")
- Waterbodies

Official Plan - Designations

- Agricultural Area
- Residential
- Special Residential Policy Area
- Commercial
- Mixed Commercial/Industrial
- Industrial
- Open Space Area

Lambton County  
Official Plan - Designations

- Urban Settlement Area Boundary
- The settlement area boundary shown is derived from the County of Lambton Official Plan and does not form part of the Brooke-Alvinston Official Plan. It is provided as a visual aid for information purposes only.

2023  
**DRAFT**

Reference

Disclaimer: These digital mapping products have been produced on the County of Lambton's Geographic Information System. Data provided herein is derived from sources with varying levels of accuracy and currency. This is not a survey product. The County of Lambton disclaims all responsibility for the accuracy or completeness of information contained herein. The County of Lambton assumes no responsibility for errors arising from use of these digital mapping products.

The Official Plan information contained herein is current as of the last recorded amendment noted under "Official Plan Amendments".

- Cadastral database is current to November 2022.

Projection: UTM NAD 83 Zone 17

Consultant: NPG Planning Solutions, April 2023.

COUNTY OF LAMBTON  
Planning and Development Services, April 2023.

www.lambtononline.ca

Area Estimator

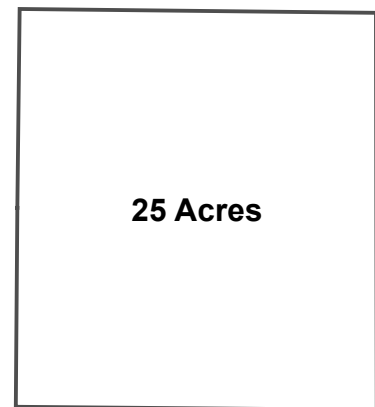

Notes: Area Estimator generalized blocks (shown at left) are scaled to represent typical area measures.  
Acre area measures can be converted to hectares (ha) by dividing by (2.471).

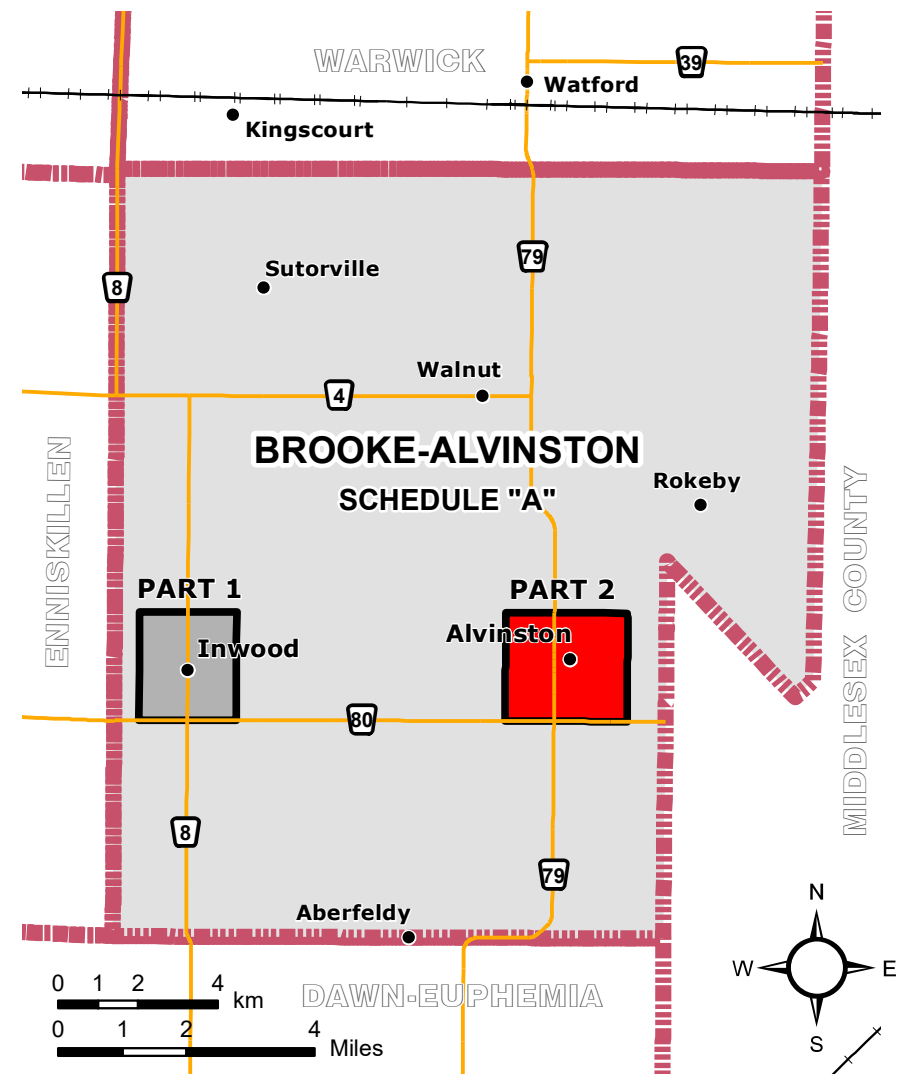
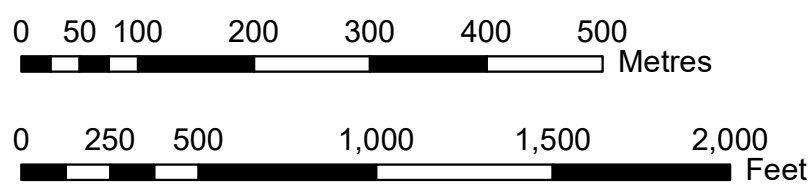
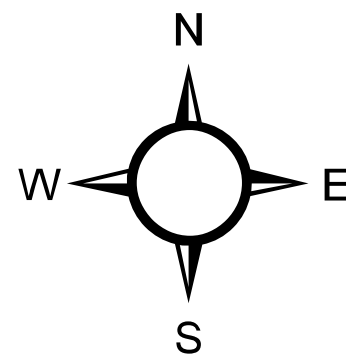

Municipality of  
Brooke-Alvinston  
**OFFICIAL PLAN**  
PART 2 to Schedule "A"  
(Alvinston)

to By-law No. \_\_ of 2023

Passed this \_\_ day of \_\_\_\_\_, 2023

David Ferguson, Mayor

Janet Denkers, Clerk-Administrator

Official Plan Amendments

xx





# Municipality of Brooke-Alvinston OFFICIAL PLAN SCHEDULE "B" Natural Heritage

## LEGEND

- Assessment Parcels
- Rivers - Streams - Drainage
- Roads
- County Roads
- Waterbodies
- Municipal Boundary
- Schedule Inset Boundaries ("Part 1" .... "Part 2")

## Lambton County Official Plan - Extract

Refer to "Chapter 8" and  
Map 2 - Natural Heritage System  
from the Lambton County Official Plan.

## Local Official Plan

- Significant Wetland
- Significant Woodland

- C6** Core Area - Feature Inventory Identifier
- 4** Feature Inventory Identifier (Generalized)
- I** Cross Municipal - Feature Inventory Identifier
- Conservation Area / Habitat Management Area (HMA) Identifier
- Group "A" Features  
(Provincially, Locally Significant Wetlands (PSW, LSW))
- Group "B" Features  
(ANSI, LS, ESA, SAA, CGP, CC, WA, PC)
- Primary Corridor (Group "C" Feature)
- Cross Municipal Corridor Feature

## Reference

Disclaimer: These digital mapping products have been produced on the County of Lambton's Geographic Information System. Data provided herein is derived from sources with varying levels of accuracy and currency. This is not a survey product. The County of Lambton disclaims all responsibility for the accuracy or completeness of information contained herein. The County of Lambton assumes no responsibility for errors arising from use of these digital mapping products.

The Official Plan information contained herein is current as of the last recorded amendment noted under "Official Plan Amendments".

- Cadastral database is current to November 2022.
- Wetlands database is current to November 2022 (MNR).

Projection: UTM NAD 83 Zone 17

Consultant: NPG Planning Solutions, April 2023.

COUNTY OF LAMBTON  
Planning and Development Services, April 2023.

[www.lambtononline.ca](http://www.lambtononline.ca)

## Area Estimator

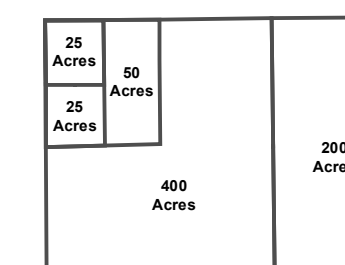

Notes: Area Estimator generalized blocks (shown at left) are scaled to represent typical area measures.  
Acre area measures can be converted to hectares (ha) by dividing by (2.471).

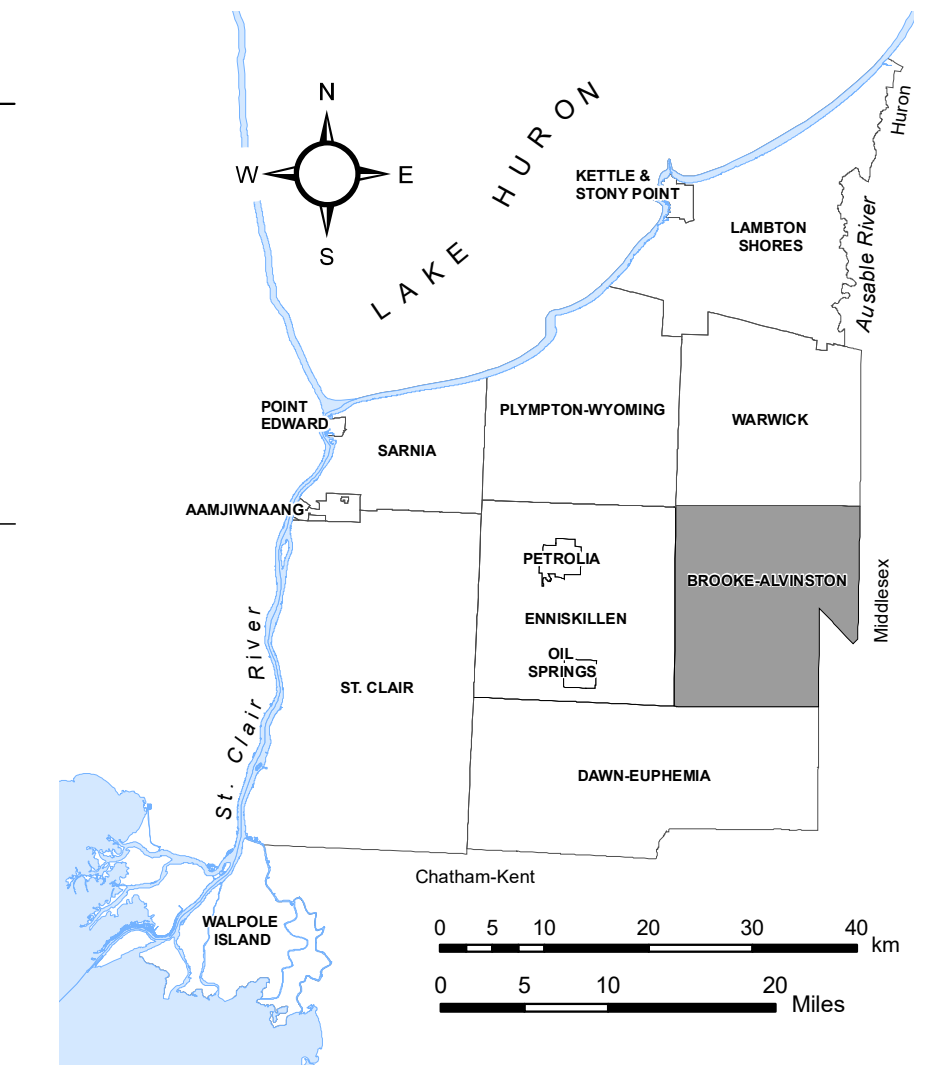
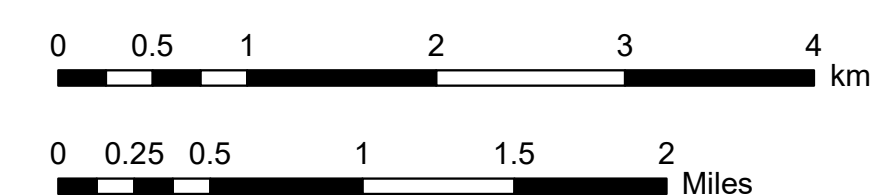
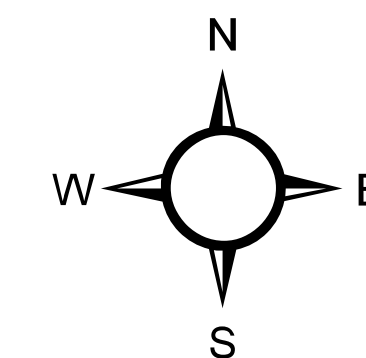

# 2023 DRAFT



## Municipality of Brooke-Alvinston OFFICIAL PLAN SCHEDULE "B" Natural Heritage

to By-law No. \_\_xx\_\_ of 2023

Passed this \_\_xx\_\_ day of xxxxxxxx, 2023

David Ferguson, Mayor

Janet Denkers, Clerk-Administrator

## Official Plan Amendments

xx





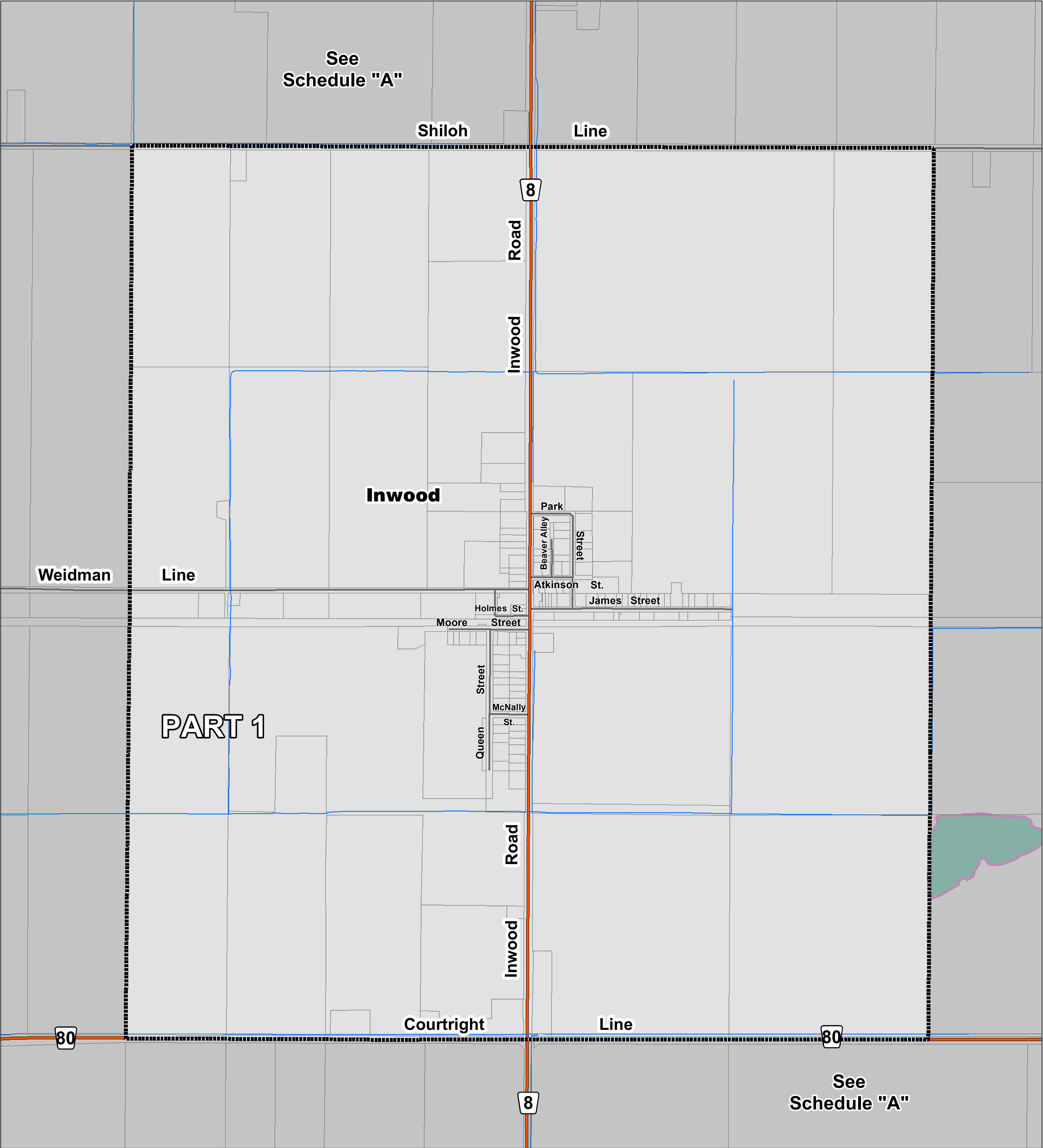

Municipality of  
Brooke-Alvinston  
**OFFICIAL PLAN**  
**PART 1 to Schedule "B"**  
**Natural Heritage**  
**(Inwood)**

**LEGEND**

Assessment Parcels

Rivers - Streams - Drainage

Roads

County Roads

Waterbodies

Municipal Boundary

Schedule Inset Boundaries ("Part 1" .... "Part 2")

**Lambton County  
Official Plan - Extract**

Refer to "Chapter 8" and Map 2 - Natural Heritage System from the Lambton County Official Plan.

**Local Official Plan**

Significant Wetland

Significant Woodland

Core Area - Feature Inventory Identifier

Feature Inventory Identifier (Generalized)

Cross Municipal - Feature Inventory Identifier

Conservation Area / Habitat Management Area (HMA) Identifier

Group "A" Features  
(Provincially, Locally Significant Wetlands (PSW, LSW))

Group "B" Features  
(ANSI, LS, ESA, SAA, CGP, CC, WA, PC)

Primary Corridor (Group "C" Feature)

Cross Municipal Corridor Feature

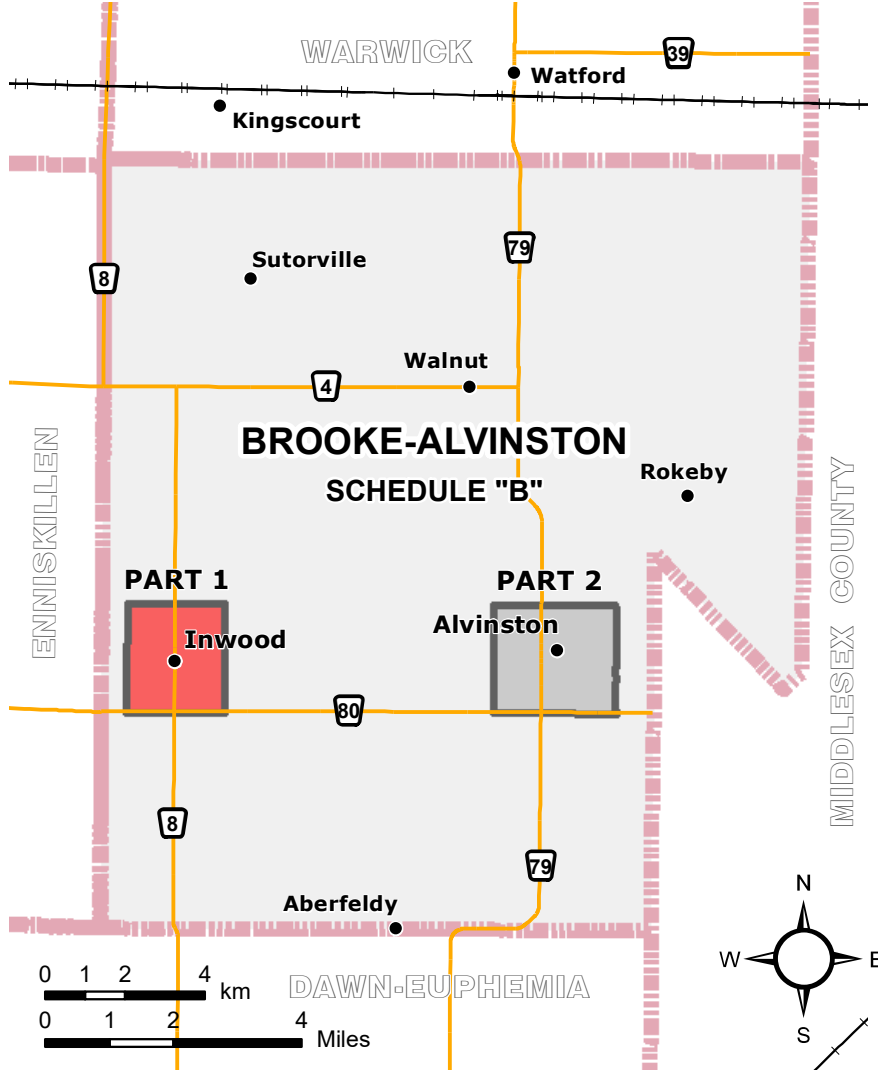

2023  
**DRAFT**



Municipality of  
Brooke-Alvinston  
**OFFICIAL PLAN**  
**PART 1 to Schedule "B"**  
**Natural Heritage**  
**(Inwood)**

to By-law No. \_\_\_\_ of 2023  
Passed this \_\_ day of \_\_\_\_\_, 2023

David Ferguson, Mayor Janet Denkers, Clerk-Administrator

**Official Plan Amendments**  
xx

**Area Estimator**

25 Acres

Notes: Area Estimator generalized blocks (shown at left) are scaled to represent typical area measures.  
Acre area measures can be converted to hectares (ha) by dividing by (2.471).

0 50 100 200 300 400 500 Metres

0 250 500 1,000 1,500 2,000 Feet

N

W

E

S





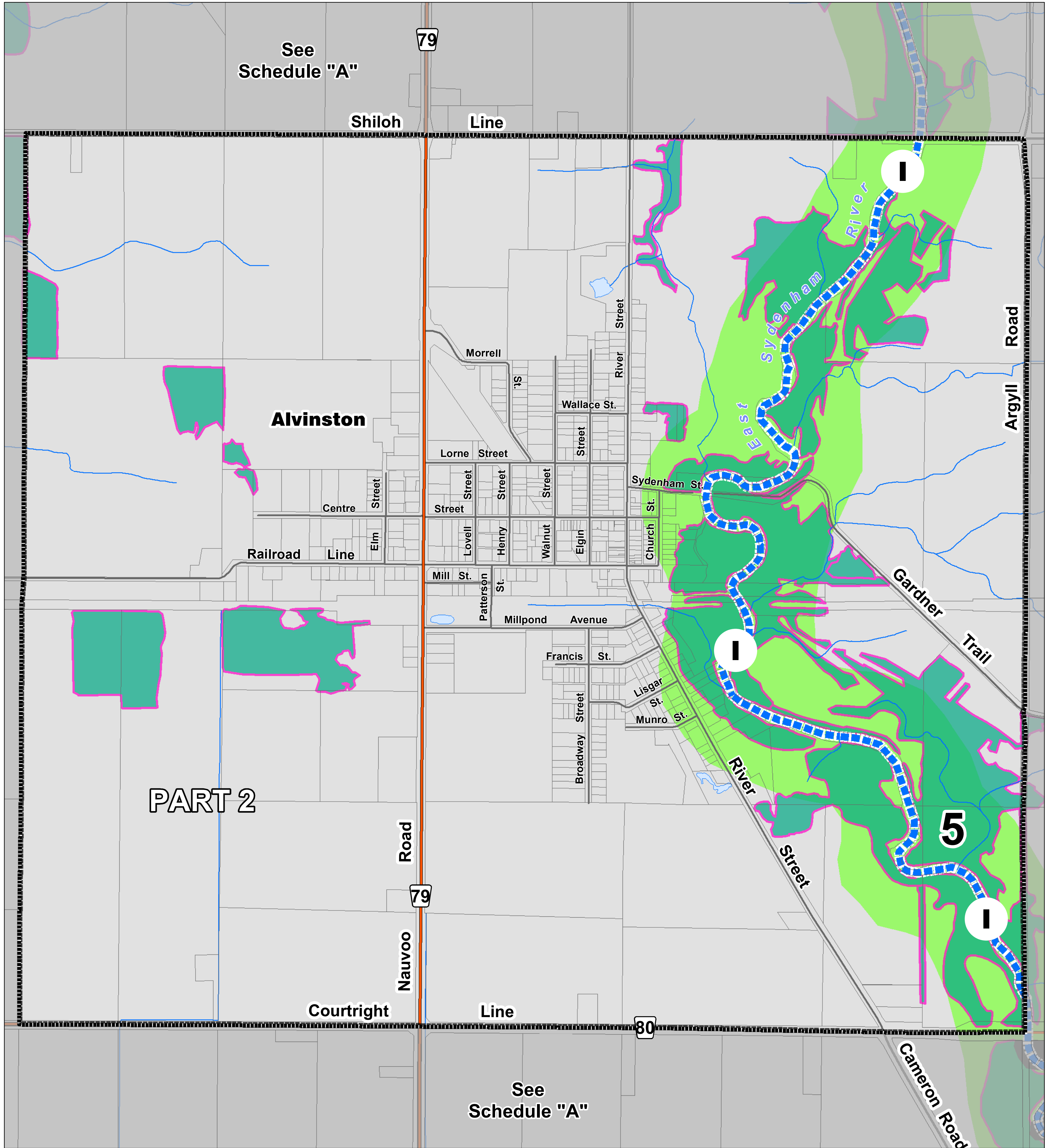

Municipality of  
Brooke-Alvinston  
**OFFICIAL PLAN**  
PART 2 to Schedule "B"  
Natural Heritage  
(Alvinston)

**LEGEND**

Assessment Parcels

Rivers - Streams - Drainage

Roads

County Roads

Waterbodies

Municipal Boundary

Schedule Inset Boundaries  
("Part 1" .... "Part 2")

**Lambton County  
Official Plan - Extract**

Refer to "Chapter 8" and  
Map 2 - Natural Heritage System  
from the Lambton County Official Plan.

**Local Official Plan**

Significant Wetland

Significant Woodland

Core Area - Feature Inventory Identifier

Feature Inventory Identifier (Generalized)

Cross Municipal - Feature Inventory Identifier

Conservation Area /  
Habitat Management Area (HMA) Identifier

Group "A" Features  
(Provincially, Locally Significant Wetlands (PSW, LSW))

Group "B" Features  
(ANSI, LS, ESA, SAA, CGP, CC, WA, PC)

Primary Corridor (Group "C" Feature)

Cross Municipal Corridor Feature

2023  
**DRAFT**

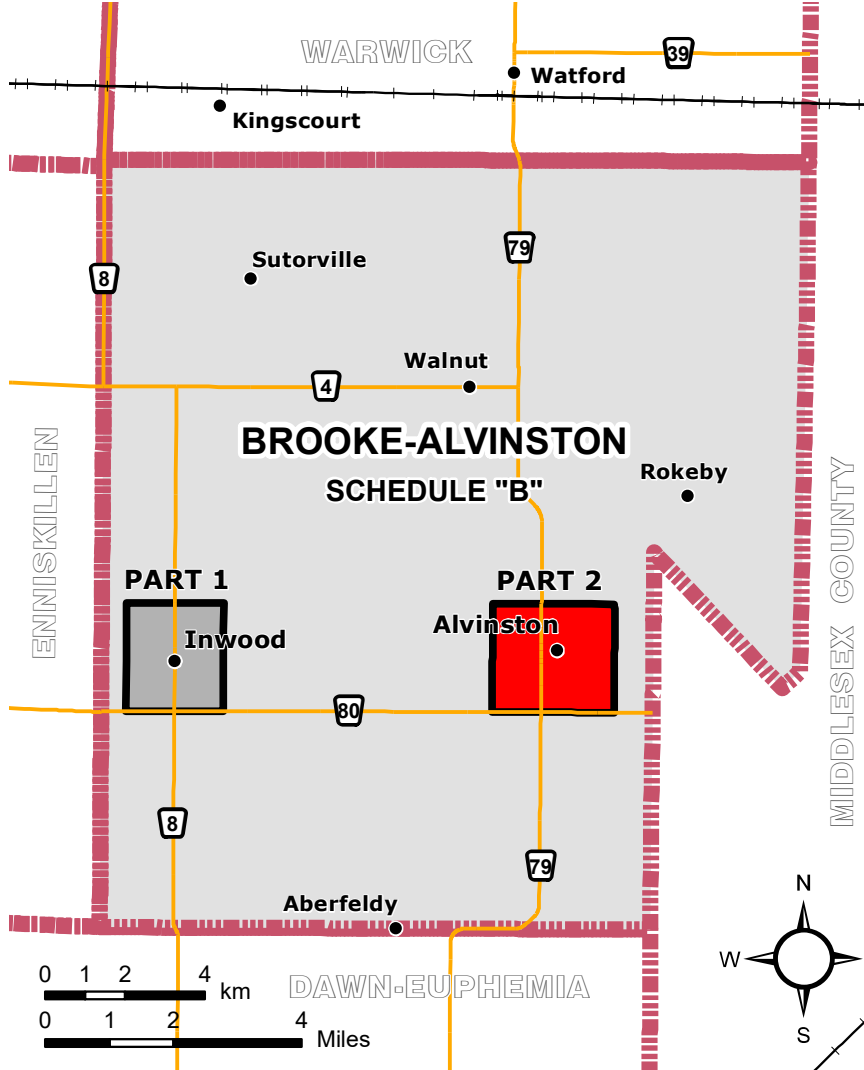

**Reference**

Disclaimer: These digital mapping products have been produced on the County of Lambton's Geographic Information System. Data provided herein is derived from sources with varying levels of accuracy and currency. This is not a survey product. The County of Lambton disclaims all responsibility for the accuracy or completeness of information contained herein. The County of Lambton assumes no responsibility for errors arising from use of these digital mapping products.

The Official Plan information contained herein is current as of the last recorded amendment noted under "Official Plan Amendments".

- Cadastral database is current to November 2022.  
- Wetlands database is current to November 2022 (MNR).

Projection: UTM NAD 83 Zone 17  
Consultant: NPG Planning Solutions, April 2023.  
COUNTY OF LAMBTON  
Planning and Development Services, April 2023.  
[www.lambtononline.ca](http://www.lambtononline.ca)

**Area Estimator**

Notes: Area Estimator generalized blocks  
(shown at left) are scaled to represent typical  
area measures.  
  
Acre area measures can be converted to  
hectares (ha) by dividing by (2.471).

North Arrow

Scale Bar



Municipality of  
Brooke-Alvinston  
**OFFICIAL PLAN**  
PART 2 to Schedule "B"  
Natural Heritage  
(Alvinston)

to By-law No. \_\_xx\_\_ of 2023  
Passed this \_\_xx\_\_ day of \_\_\_\_\_, 2023

David Ferguson, Mayor Janet Denkers, Clerk-Administrator

**Official Plan Amendments**  
xx





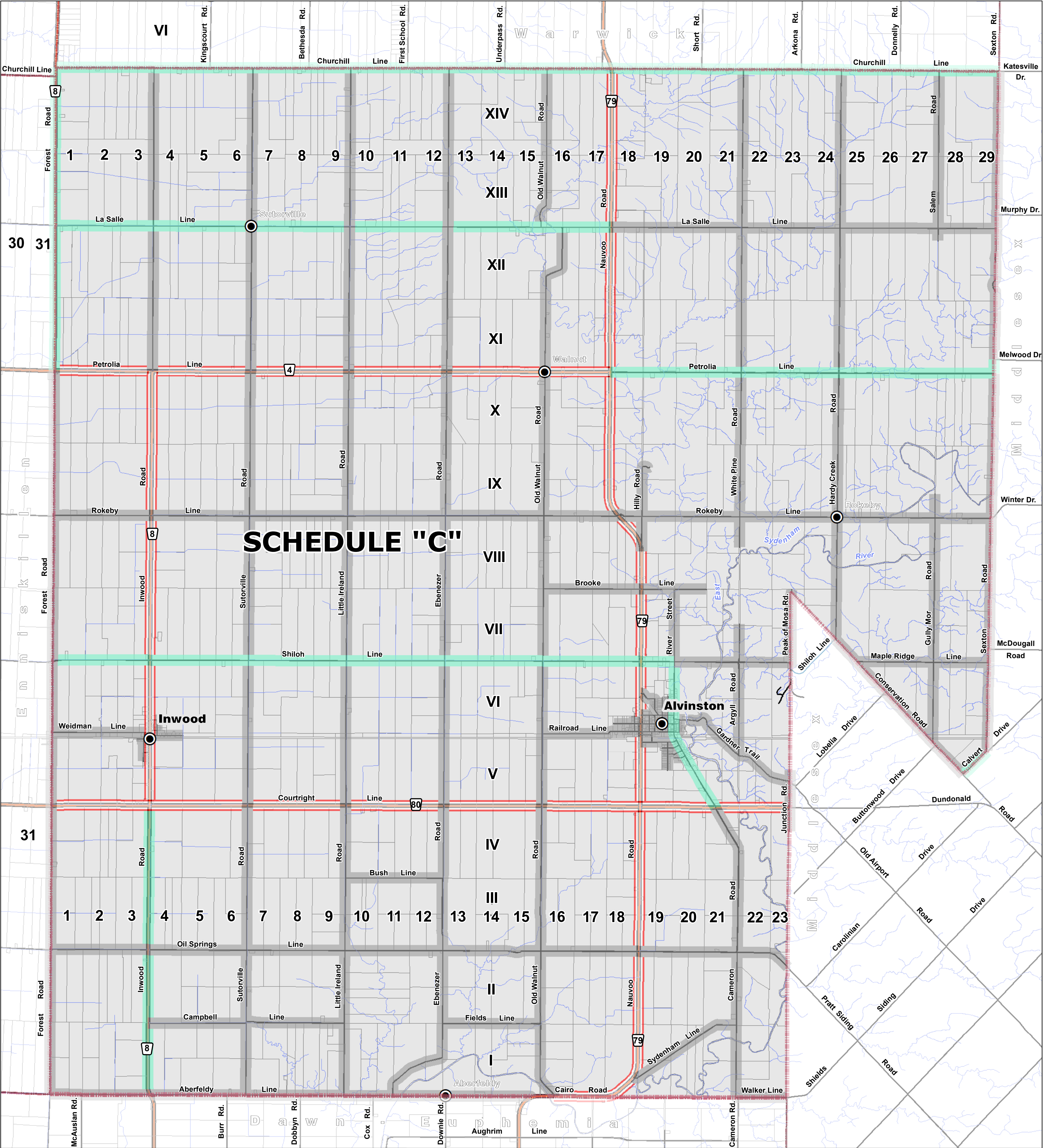

Municipality of  
Brooke-Alvinston  
**OFFICIAL PLAN**  
**SCHEDULE "C"**  
Roads Plan

LEGEND

- Assessment Parcels
- Rivers - Streams - Drainage
- Roads
- Township Boundary
- Waterbodies
- County Roads

Official Plan - Roads Plan

- Arterial Road
- Collector Road
- Local Road

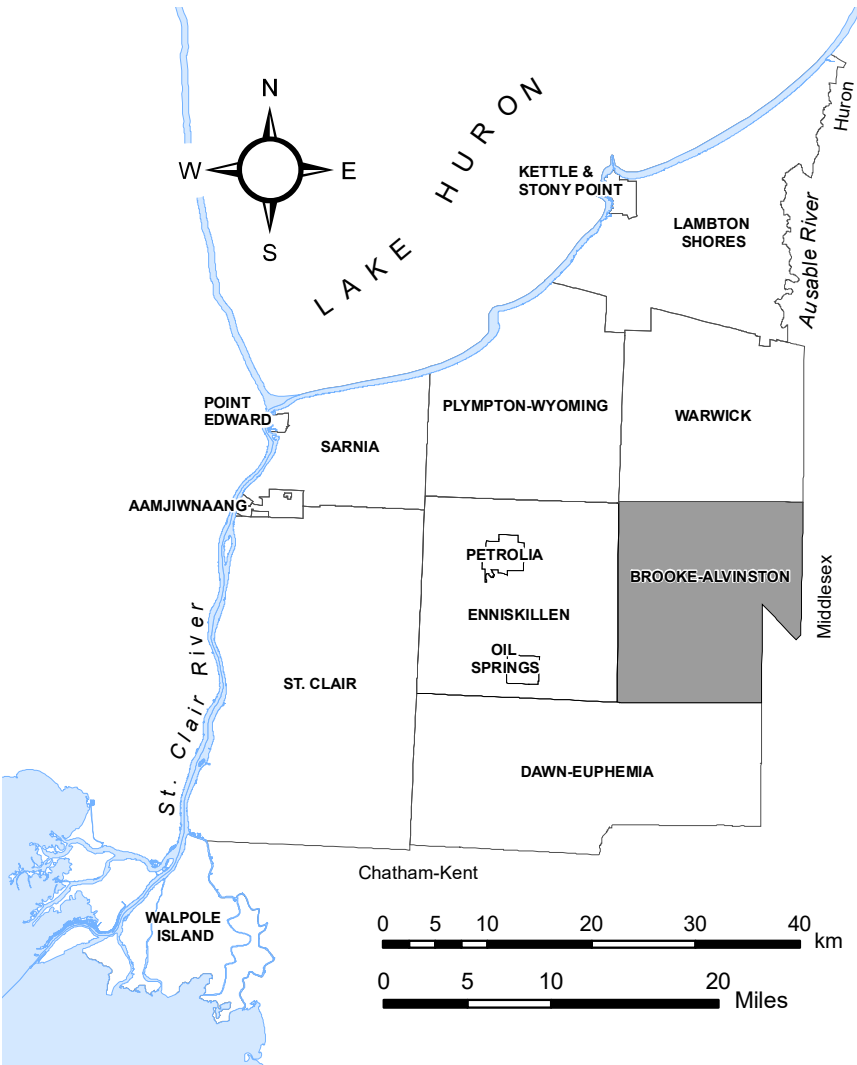

2023  
**DRAFT**

Reference

Disclaimer: These digital mapping products have been produced on the County of Lambton's Geographic Information System. Data provided herein is derived from sources with varying levels of accuracy and currency. This is not a survey product. The County of Lambton disclaims all responsibility for the accuracy or completeness of information contained herein. The County of Lambton assumes no responsibility for errors arising from use of these digital mapping products.

The Official Plan information contained herein is current as of the last recorded amendment noted under "Official Plan Amendments".

- Cadastral database is current to November 2022.

Projection: UTM NAD 83 Zone 17

Consultant: NPG Planning Solutions, April 2023.

COUNTY OF LAMBTON  
Planning and Development Services, April 2023.

www.lambtononline.ca

Area Estimator

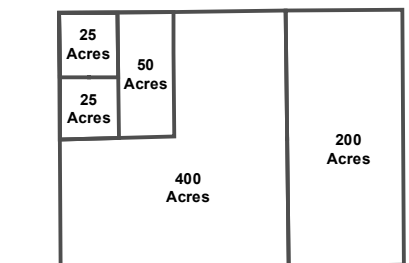

Notes: Area Estimator generalized blocks (shown at left) are scaled to represent typical area measures.

Acre area measures can be converted to hectares (ha) by dividing by (2.471).

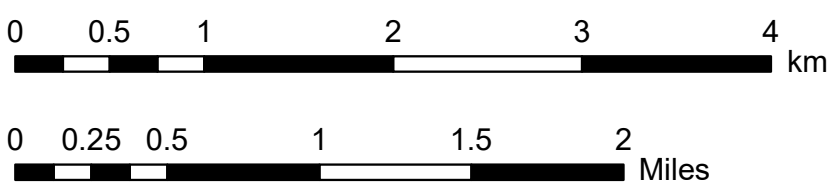
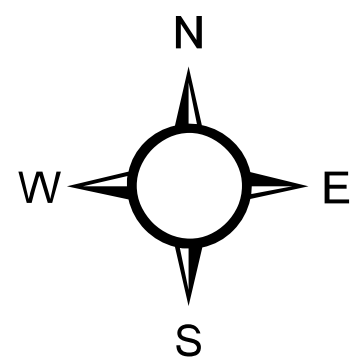

Municipality of  
Brooke-Alvinston  
**OFFICIAL PLAN**  
**SCHEDULE "C"**  
Roads Plan

to By-law No. \_\_xx\_\_ of 2023

Passed this \_\_xx\_\_ day of xxxxxxxx ,2023

David Ferguson, Mayor

Janet Denkers, Clerk-Administrator

Official Plan Amendments

xx





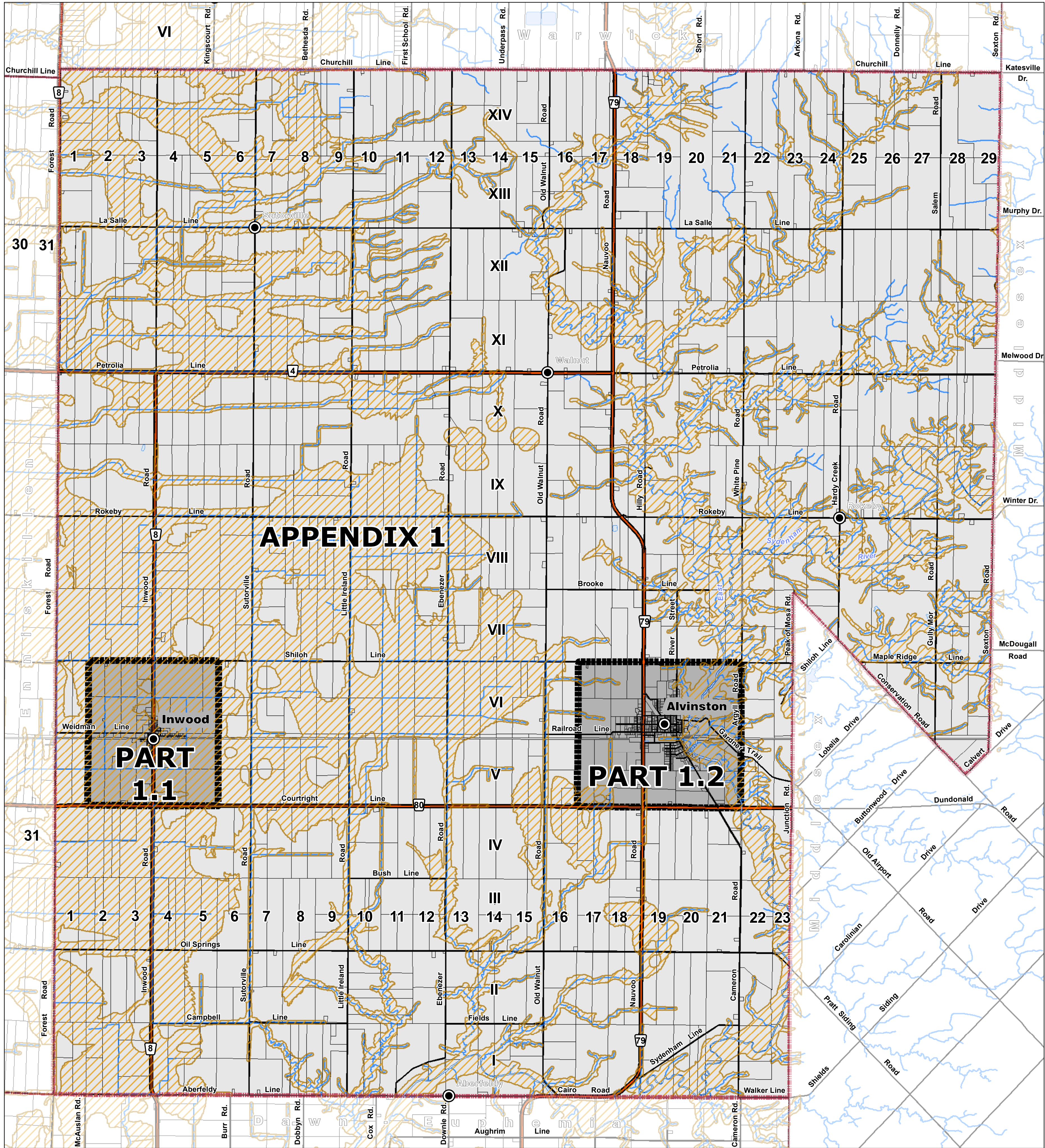

Municipality of  
Brooke-Alvinston  
**OFFICIAL PLAN**  
**APPENDIX 1**  
**Conservation Authority Regulated Areas**

**LEGEND**

- Assessment Parcels
- Rivers - Streams - Drainage
- Roads
- County Roads
- Waterbodies
- Municipal Boundary
- Schedule Inset Boundaries ("Part 1" .... "Part 2")

**Thematic Legend**

- Areas Affected by Regulation (Conservation Authority Regulation 171/06)

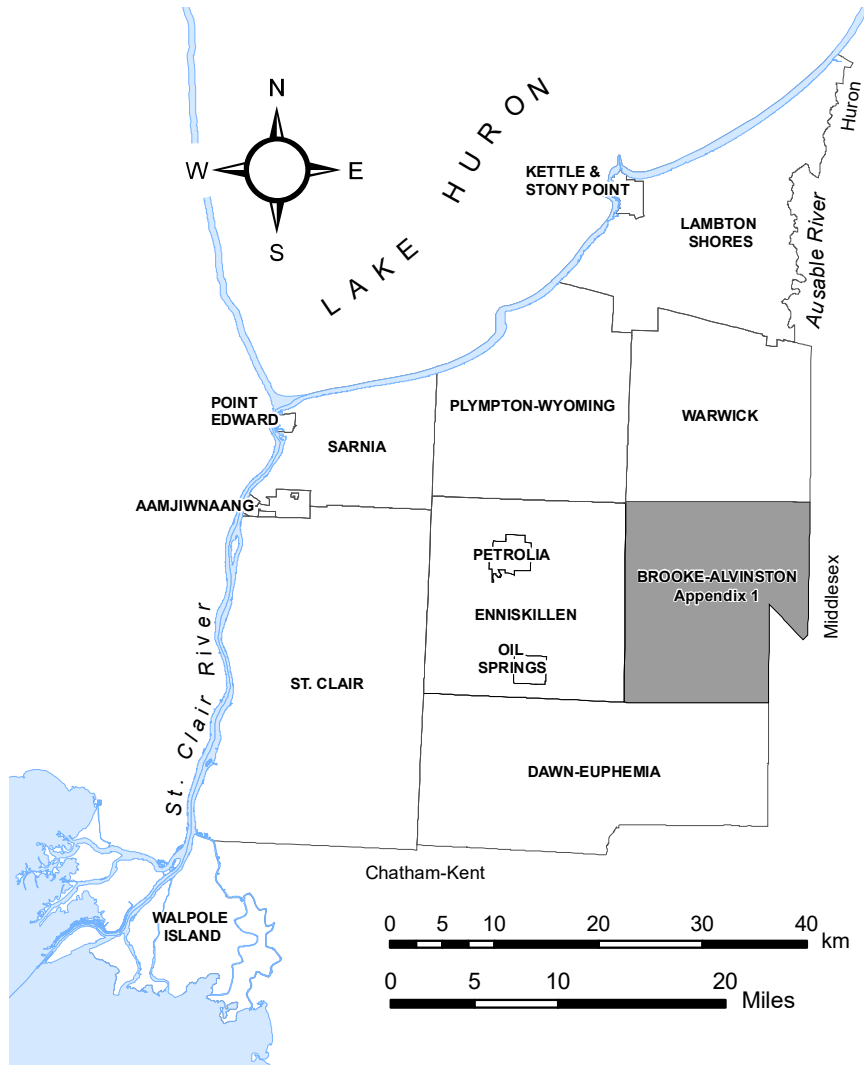

2023  
**DRAFT**



Municipality of  
Brooke-Alvinston  
**OFFICIAL PLAN**  
**APPENDIX 1**  
**Conservation Authority Regulated Areas**

**Reference**

Disclaimer: These digital mapping products have been produced on the County of Lambton's Geographic Information System. Data provided herein is derived from sources with varying levels of accuracy and currency. This is not a survey product. The County of Lambton disclaims all responsibility for the accuracy or completeness of information contained herein. The County of Lambton assumes no responsibility for errors arising from use of these digital mapping products.

The Official Plan information contained herein is current as of the last recorded amendment noted under "Official Plan Amendments".

- Cadastral database is current to November 2022.
- Hazard Areas are determined by local Conservation Authorities and are Subject to Change.

Projection: UTM NAD 83 Zone 17

Consultant: NPG Planning Solutions, April 2023.

COUNTY OF LAMBTON  
Planning and Development Services, April 2023.

[www.lambtononline.ca](http://www.lambtononline.ca)

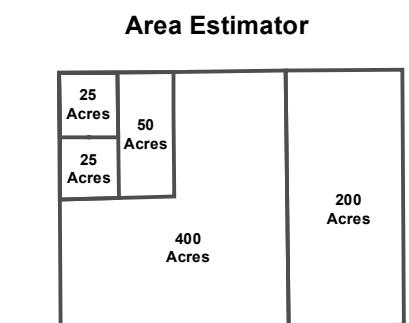

Notes: Area Estimator generalized blocks (shown at left) are scaled to represent typical area measures.  
Acre area measures can be converted to hectares (ha) by dividing by (2.471).

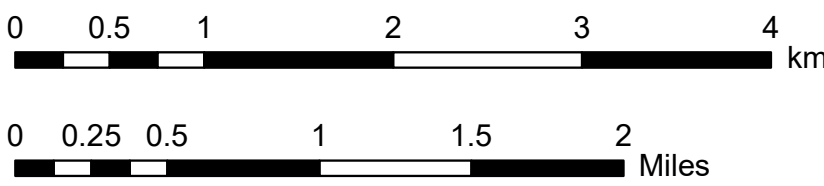
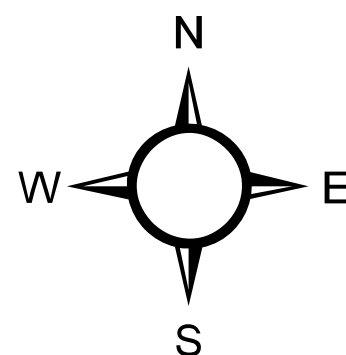

to By-law No. \_\_xx\_\_ of 2023

Passed this \_\_xx\_\_ day of xxxxxxxx, 2023

David Ferguson, Mayor

Janet Denkers, Clerk-Administrator

**Appendix Amendments**

xx





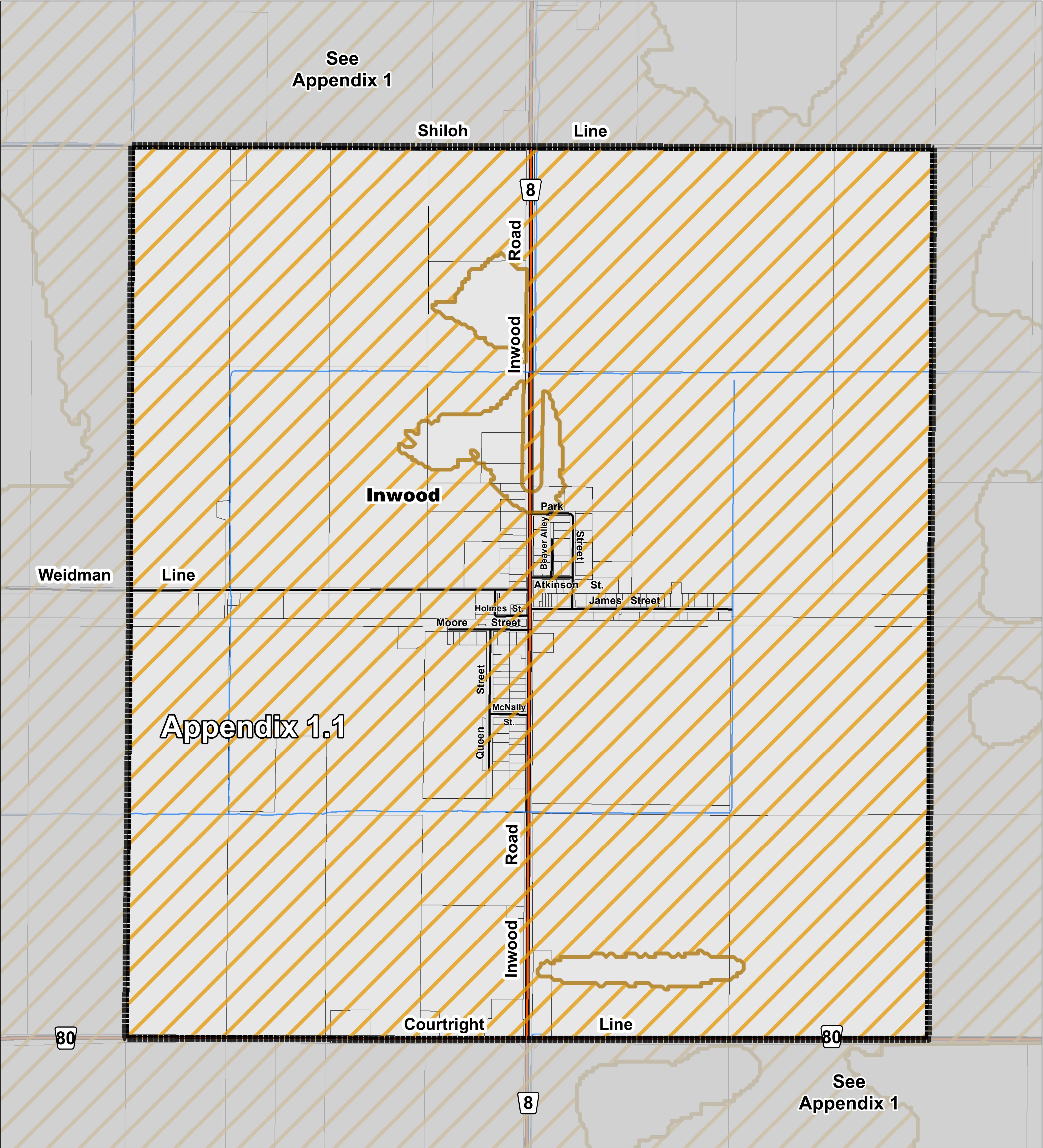

Municipality of  
Brooke-Alvinston  
**OFFICIAL PLAN**  
**APPENDIX 1.1**  
**Conservation Authority Regulated Areas**  
**(Inwood)**

**LEGEND**

Assessment Parcels	Waterbodies
Rivers - Streams - Drainage	Municipal Boundary
Roads	County Roads
	Schedule Inset Boundaries ("Part 1" .... "Part 2")

**Thematic Legend**

Areas Affected by Regulation (Conservation Authority Regulation 171/06)

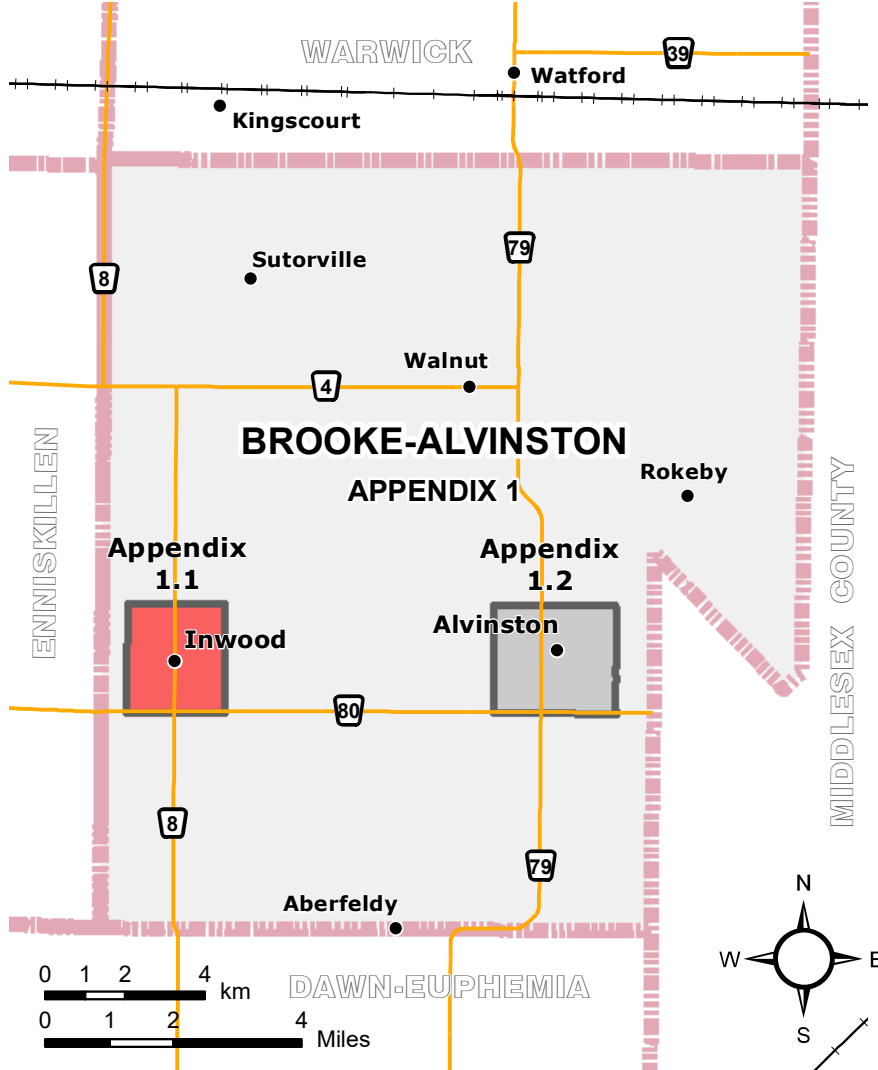

2023  
**DRAFT**



Municipality of  
Brooke-Alvinston  
**OFFICIAL PLAN**  
**APPENDIX 1.1**  
**Conservation Authority Regulated Areas**  
**(Inwood)**

to By-law No. \_\_xx\_\_ of 2023

Passed this \_\_xx\_\_ day of xxxxxxxx, 2023

David Ferguson, Mayor

Janet Denkers, Clerk-Administrator

**Appendix Amendments**

xx

**Reference**

Disclaimer: These digital mapping products have been produced on the County of Lambton's Geographic Information System. Data provided herein is derived from sources with varying levels of accuracy and currency. This is not a survey product. The County of Lambton disclaims all responsibility for the accuracy or completeness of information contained herein. The County of Lambton assumes no responsibility for errors arising from use of these digital mapping products.

The Official Plan information contained herein is current as of the last recorded amendment noted under "Official Plan Amendments".

- Cadastral database is current to November 2022.  
- Hazard Areas are determined by local Conservation Authorities and are Subject to Change.

Projection: UTM NAD 83 Zone 17

Consultant: NPG Planning Solutions, April 2023.

COUNTY OF LAMBTON  
Planning and Development Services, April 2023.

[www.lambtononline.ca](http://www.lambtononline.ca)

**Area Estimator**

25 Acres

Notes: Area Estimator generalized blocks (shown at left) are scaled to represent typical area measures.

Acre area measures can be converted to hectares (ha) by dividing by (2.471).

0 50 100 200 300 400 500 Metres

0 250 500 1,000 1,500 2,000 Feet

North Arrow





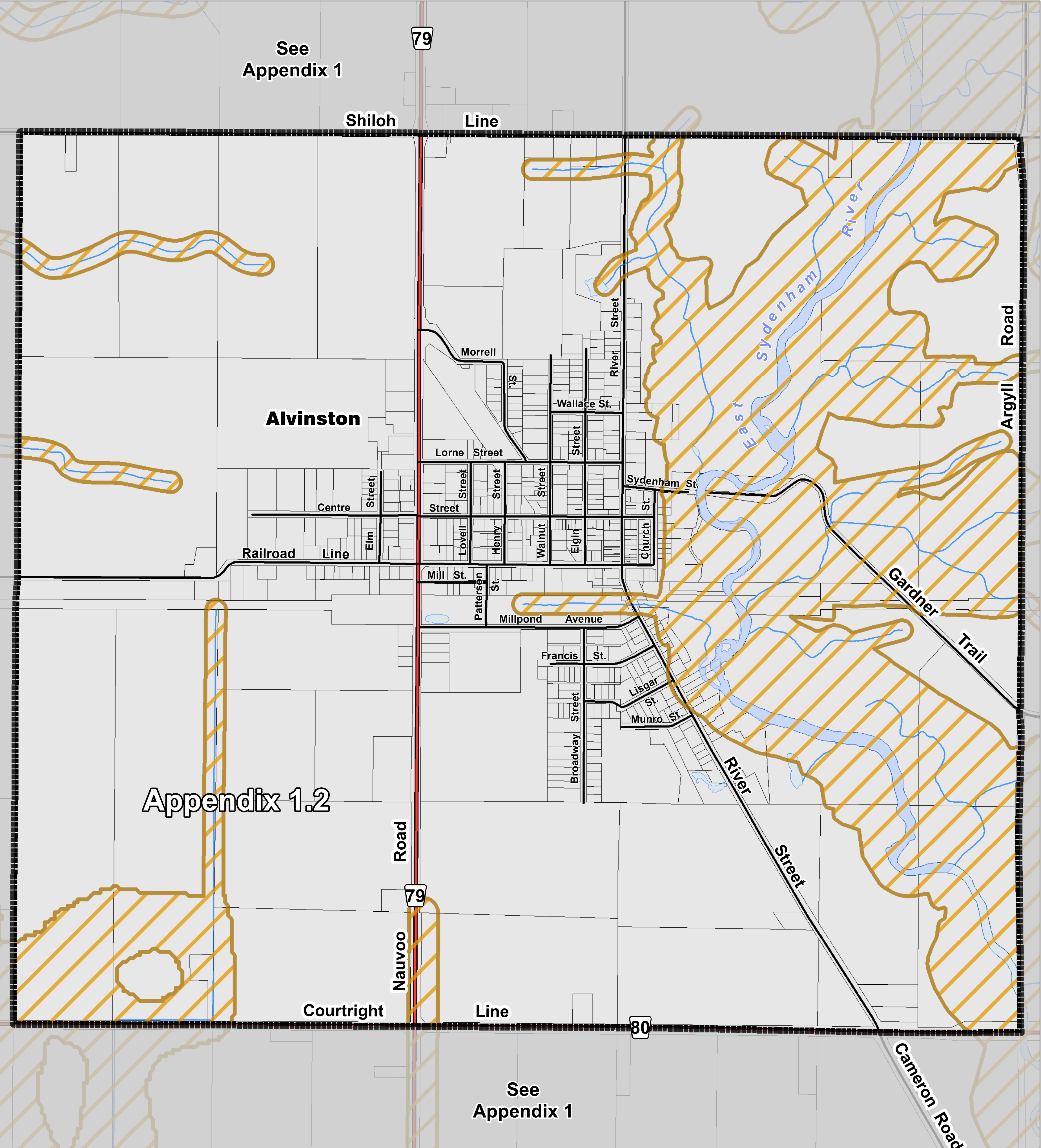

Municipality of  
Brooke-Alvinston  
**OFFICIAL PLAN**  
**APPENDIX 1.2**  
**Conservation Authority Regulated Areas**  
**(Alvinston)**

**LEGEND**

	Assessment Parcels		Waterbodies
	Rivers - Streams - Drainage		Municipal Boundary
	Roads		County Roads
	Schedule Inset Boundaries ("Part 1" .... "Part 2")		

**Thematic Legend**

	Areas Affected by Regulation (Conservation Authority Regulation 171/06)
--	-------------------------------------------------------------------------

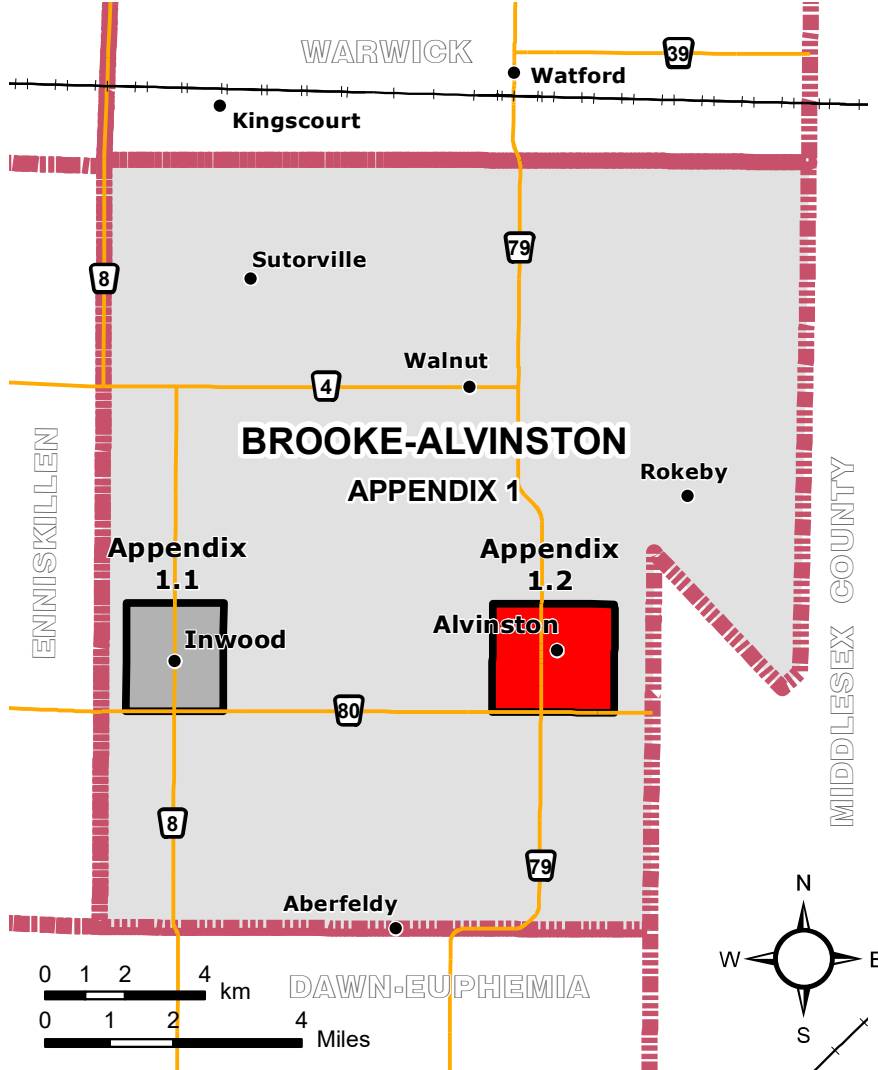

**Reference**

Disclaimer: These digital mapping products have been produced on the County of Lambton's Geographic Information System. Data provided herein is derived from sources with varying levels of accuracy and currency. This is not a survey product. The County of Lambton disclaims all responsibility for the accuracy or completeness of information contained herein. The County of Lambton assumes no responsibility for errors arising from use of these digital mapping products.

The Official Plan information contained herein is current as of the last recorded amendment noted under "Official Plan Amendments".

- Cadastral database is current to November 2022.  
- Hazard Areas are determined by local Conservation Authorities and are Subject to Change.

Projection: UTM NAD 83 Zone 17

Consultant: NPG Planning Solutions, April 2023.

COUNTY OF LAMBTON  
Planning and Development Services, April 2023.

[www.lambtononline.ca](http://www.lambtononline.ca)

**Area Estimator**

25 Acres

Notes: Area Estimator generalized blocks (shown at left) are scaled to represent typical area measures.  
Acre area measures can be converted to hectares (ha) by dividing by (2.471).

0 50 100 200 300 400 500 Metres

0 250 500 1,000 1,500 2,000 Feet

W N E S



Municipality of  
Brooke-Alvinston  
**OFFICIAL PLAN**  
**APPENDIX 1.2**  
**Conservation Authority Regulated Areas**  
**(Alvinston)**

to By-law No. \_\_xx\_\_ of 2023

Passed this \_\_xx\_\_ day of \_\_\_\_\_, 2023

David Ferguson, Mayor Janet Denkers, Clerk-Administrator

**Appendix Amendments**  
xx





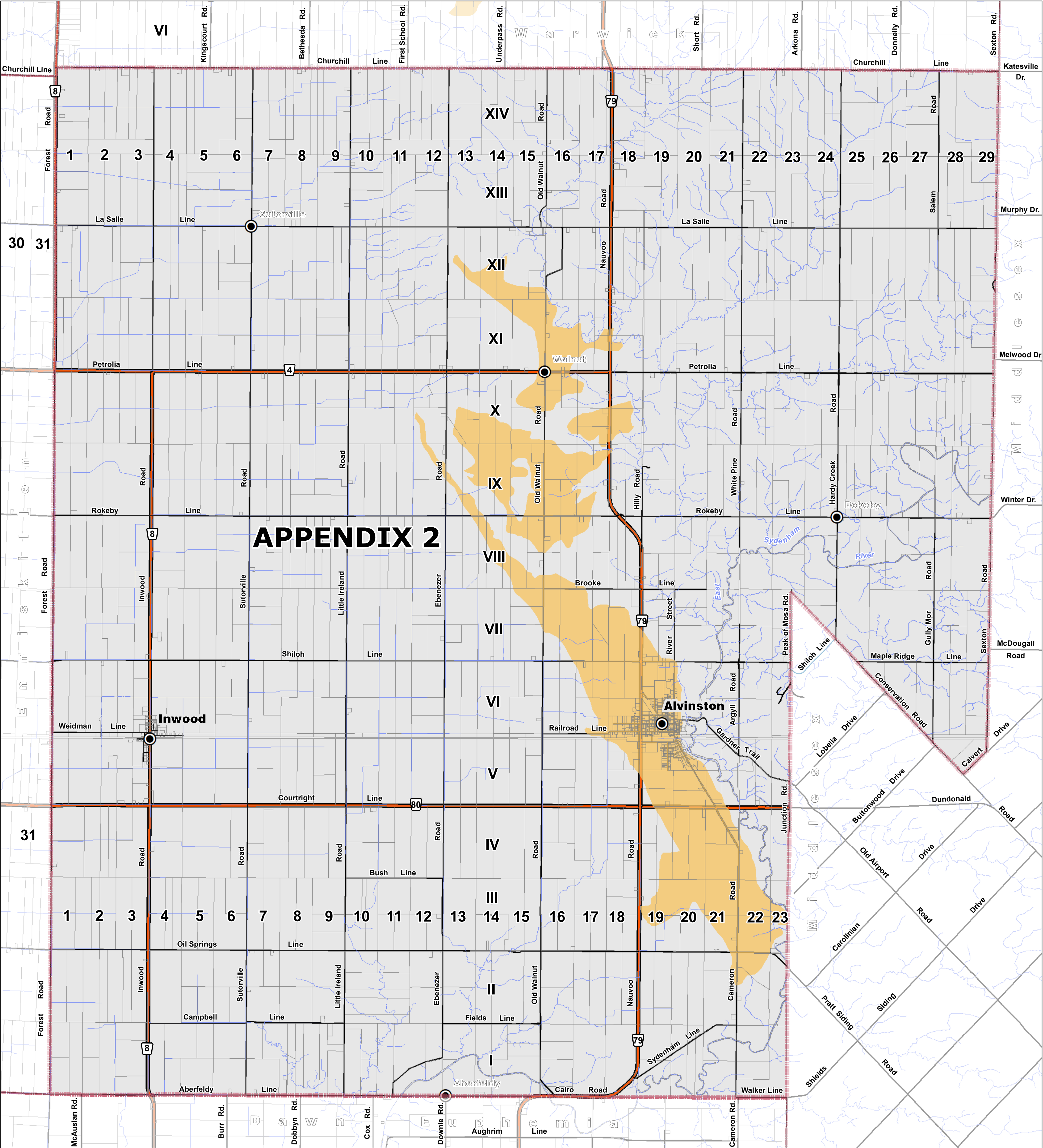

# Municipality of Brooke-Alvinston OFFICIAL PLAN APPENDIX 2 Mineral Aggregate Resources

## LEGEND

- Assessment Parcels
- Rivers - Streams - Drainage
- Roads
- County Roads
- Municipal Boundary
- Waterbodies

## Thematic Legend

- Aggregate Site (Authorized Active - ARO June 2021)  
No "Authorized Active" sites in Brooke-Alvinston at time of map compilation
- Potential Aggregate Deposit - As Extracted from Lambton County "Official Plan" - Appendix Map "B" - Mineral Aggregate Resources

Data is drawn from the Ontario Geological Survey 2010, [MRD128-REV] (Surficial Geology of Southern Ontario) and represents potential locations of mineral aggregate resources in Lambton County. Lambton County has never been appraised by the Ontario Ministry of Northern Development and Mines (MNDM) to formally assess these aggregate resources for potential as mineral deposits of sufficient quantity and quality based on specific geological evidence to warrant present or future extraction.

Aggregate Sites (Authorized Active) ARO - June 2021.  
Aggregate Resources of Ontario (ARO).

## Reference

Disclaimer: These digital mapping products have been produced on the County of Lambton's Geographic Information System. Data provided herein is derived from sources with varying levels of accuracy and currency. This is not a survey product. The County of Lambton disclaims all responsibility for the accuracy or completeness of information contained herein. The County of Lambton assumes no responsibility for errors arising from use of these digital mapping products.

The Official Plan information contained herein is current as of the last recorded amendment noted under "Official Plan Amendments".

- Cadastral database is current to November 2022.

Projection: UTM NAD 83 Zone 17

Consultant: NPG Planning Solutions, April 2023.

COUNTY OF LAMBTON  
Planning and Development Services, April 2023.

[www.lambtononline.ca](http://www.lambtononline.ca)

## Area Estimator

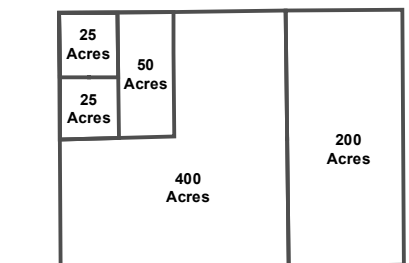

Notes: Area Estimator generalized blocks (shown at left) are scaled to represent typical area measures.  
Acre area measures can be converted to hectares (ha) by dividing by (2.471).

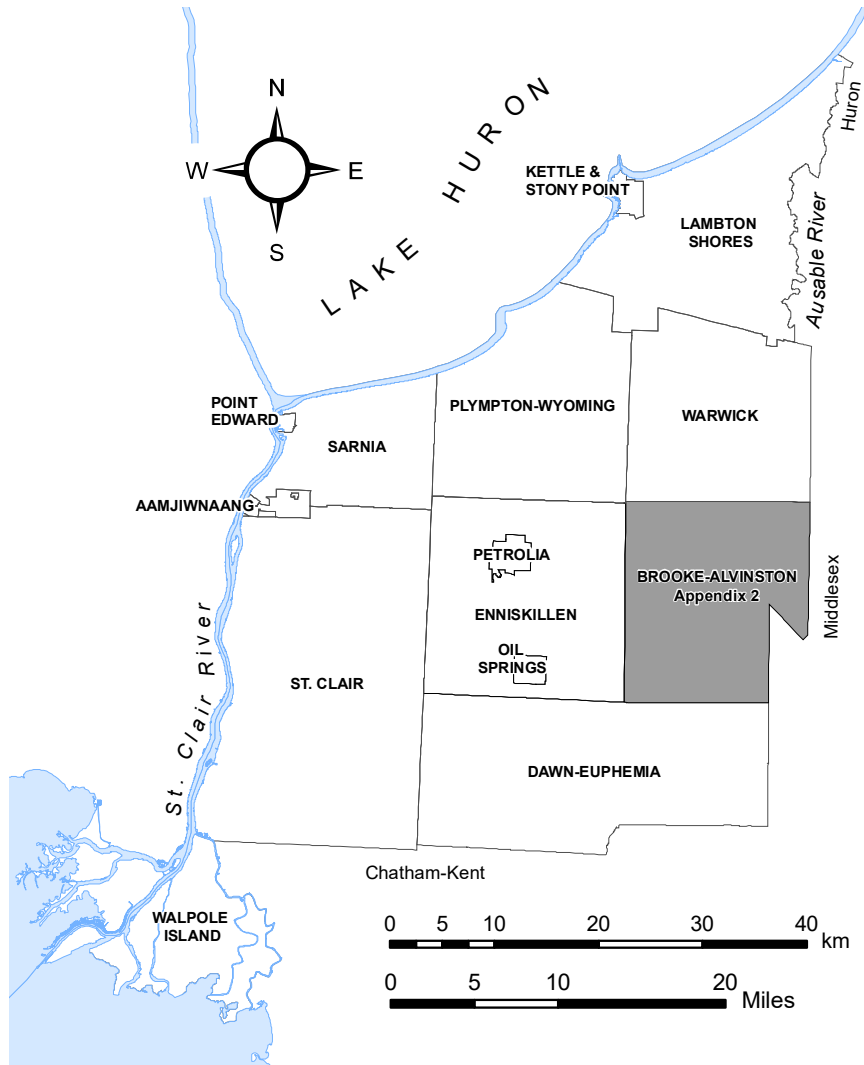
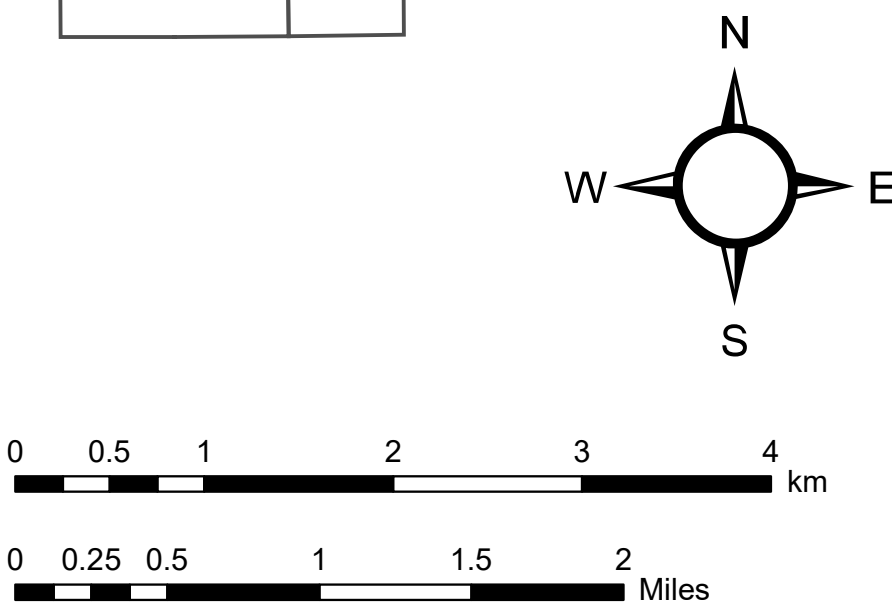

# 2023 DRAFT



## Municipality of Brooke-Alvinston OFFICIAL PLAN APPENDIX 2 Mineral Aggregate Resources

to By-law No. \_\_xx\_\_ of 2023

Passed this \_\_xx\_\_ day of xxxxxxxx, 2023

David Ferguson, Mayor

Janet Denkers, Clerk-Administrator

## Appendix Amendments

xx









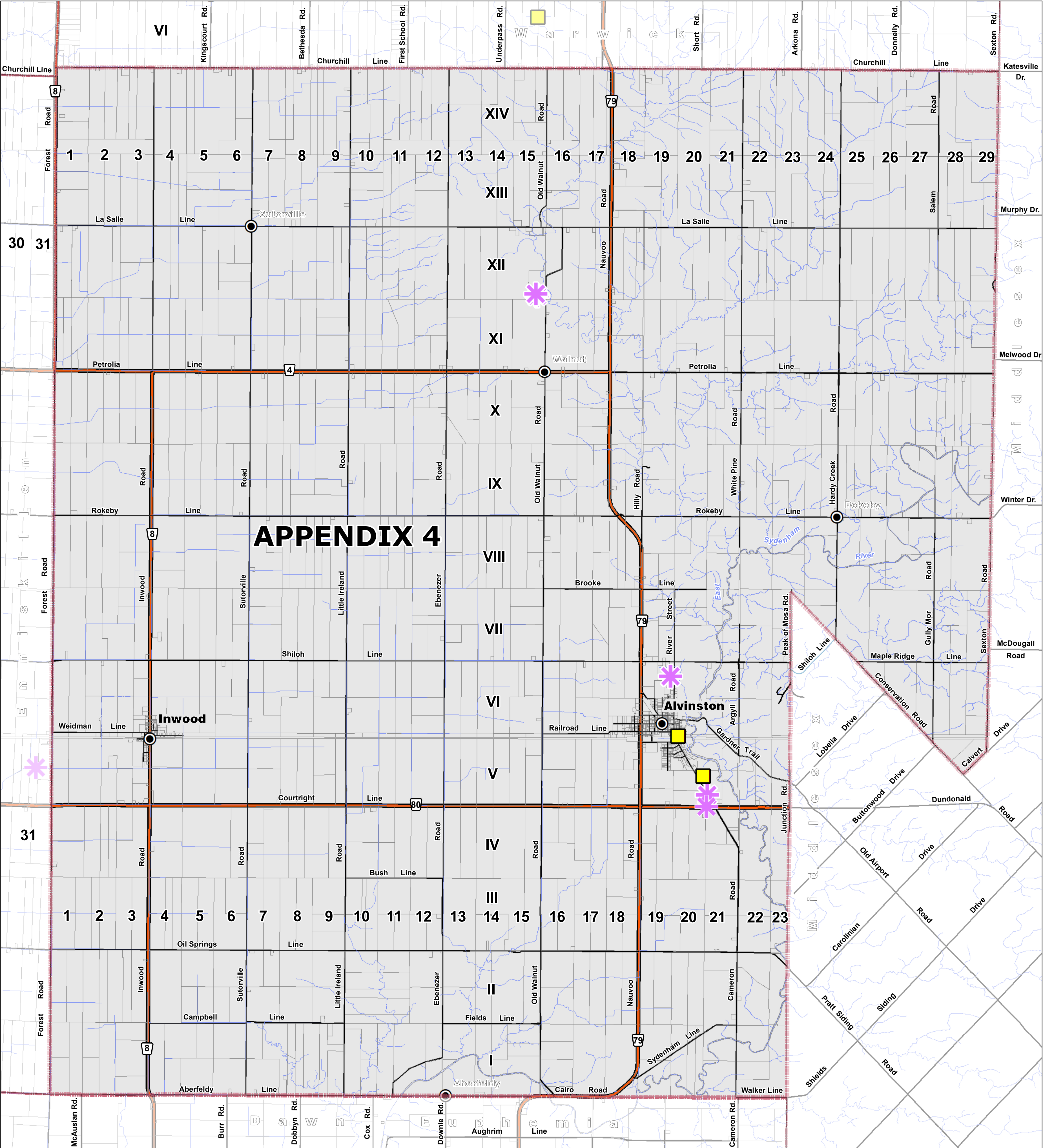

Municipality of  
Brooke-Alvinston  
**OFFICIAL PLAN**  
**APPENDIX 4**  
**Waste Disposal Sites**

**LEGEND**

- Assessment Parcels
- Rivers - Streams - Drainage
- Roads
- County Roads
- Municipal Boundary
- Waterbodies

**Thematic Legend**

- Sewage Treatment Works
- Former Waste Disposal Site (Anderson Dataset: Lambton GWS 2004)

Data is drawn from the Lambton Groundwater Study December 2004. Project No. 03-2434  
Dillon Consulting Limited in Association with Golder Associates Ltd.  
Anderson Waste Sites - Map(s) 6.1, 6.2.

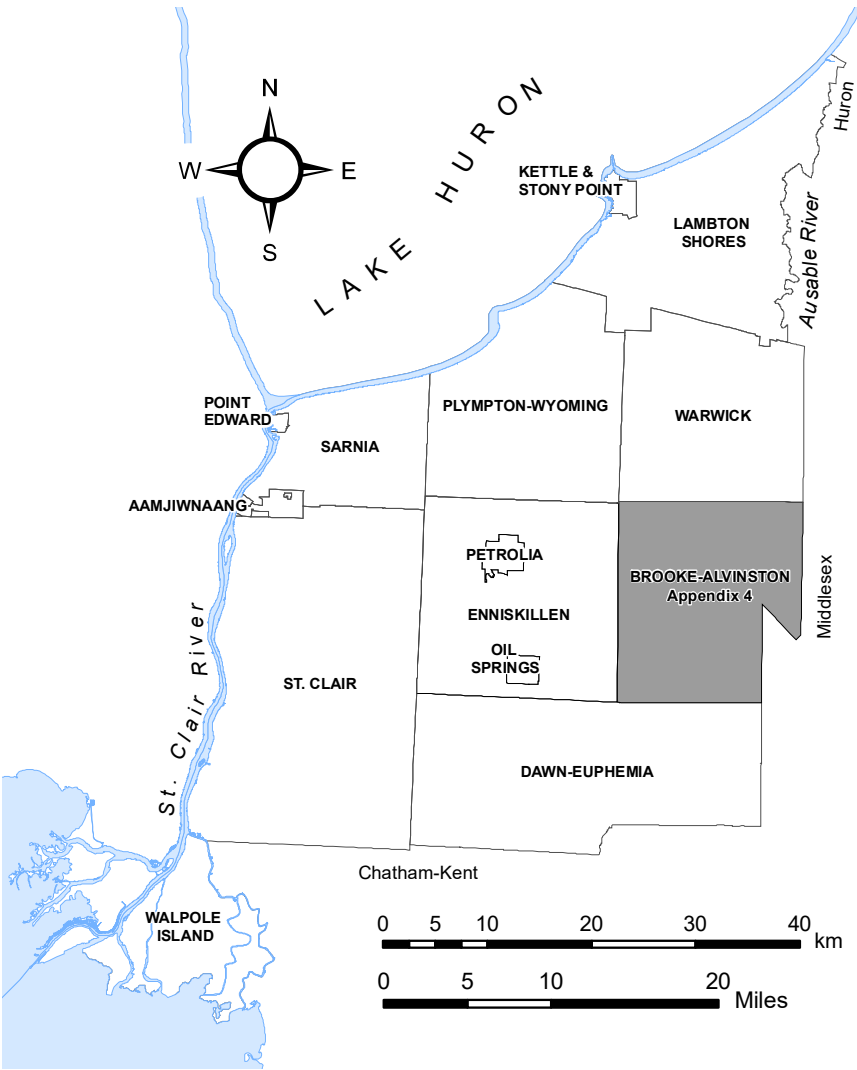

2023  
**DRAFT**

**Reference**

Disclaimer: These digital mapping products have been produced on the County of Lambton's Geographic Information System. Data provided herein is derived from sources with varying levels of accuracy and currency. This is not a survey product. The County of Lambton disclaims all responsibility for the accuracy or completeness of information contained herein. The County of Lambton assumes no responsibility for errors arising from use of these digital mapping products.

The Official Plan information contained herein is current as of the last recorded amendment noted under "Official Plan Amendments".

**NOTE: This Appendix does not form part of this Plan and is provided for information purposes only.**

- Cadastral database is current to November 2022.

Projection: UTM NAD 83 Zone 17

Consultant: NPG Planning Solutions, April 2023.

COUNTY OF LAMBTON  
Planning and Development Services, April 2023.

[www.lambtononline.ca](http://www.lambtononline.ca)

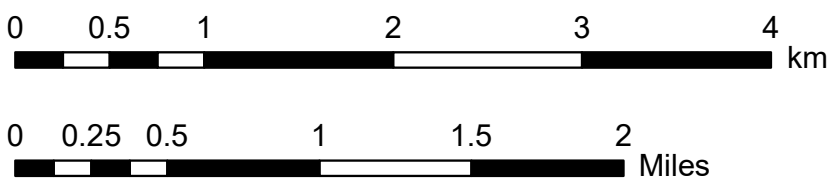
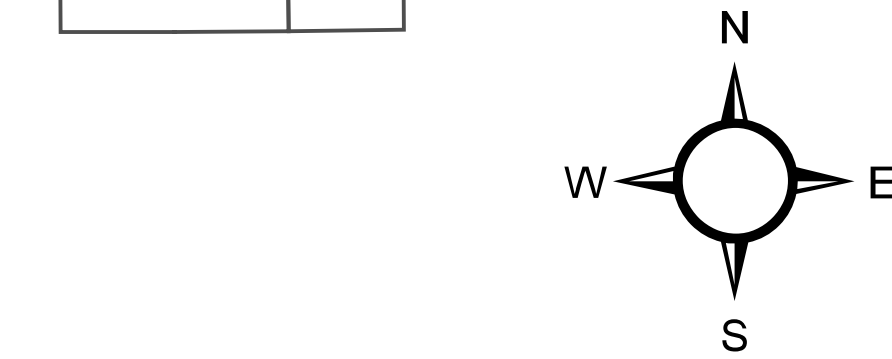
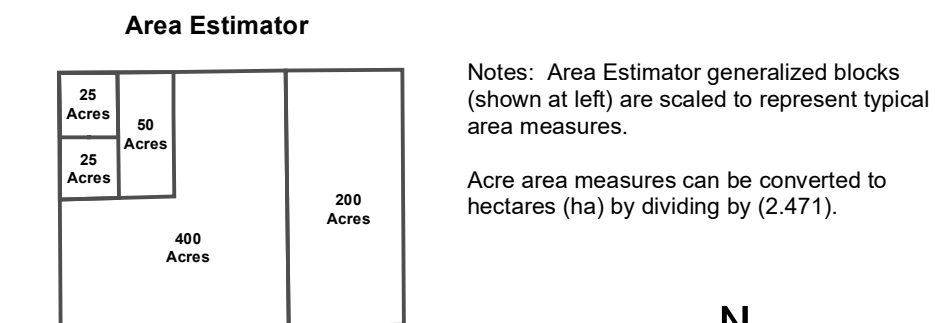

Municipality of  
Brooke-Alvinston  
**OFFICIAL PLAN**  
**APPENDIX 4**  
**Waste Disposal Sites**

to By-law No. \_\_xx\_\_ of 2023  
Passed this \_\_xx\_\_ day of xxxxxxxx, 2023

David Ferguson, Mayor Janet Denkers, Clerk-Administrator

**Appendix Amendments**

xx

